

Mark	Function	Level	Rough Height	Rough Width	Door panel height	Door panel width	Door lining O/A height	Door lining O/A width	Comments
-01	Exterior	Existing first floor plan	2035	840	1981	762	2030	830	
1-03	Interior	Existing first floor plan	2035	840	1981	762	2030	830	
1-04	Interior	Existing first floor plan	2035	840	1981	762	2030	830	
1-05	Interior	Existing first floor plan	2035	840	1981	762	2030	830	
1-06	Interior	Existing first floor plan	2035	840	1981	762	2030	830	
2-02	Interior	Existing first floor plan	2035	840	1981	762	2030	830	
2-06	Interior	Existing first floor plan	2035	840	1981	762	2030	830	
2-01	Interior	Existing first floor plan	2035	916	1981	838	2030	906	
1-01	Interior	Existing first floor plan	2035	916	1981	838	2030	906	
1-02	Interior	Existing first floor plan	2035	916	1981	838	2030	906	
2-05	Interior	Existing first floor plan	2035	840	1981	762	2030	830	
2-03	Interior	Existing first floor plan	2035	688	1981	610	2030	678	
2-04	Interior	Existing first floor plan	2035	840	1981	762	2030	830	

Window tag	Width	Height	Comments
W-01	3350	1200	Acoustic window (Triple glazed)
W-04	650	1350	Skylight
W-05	650	1350	Skylight

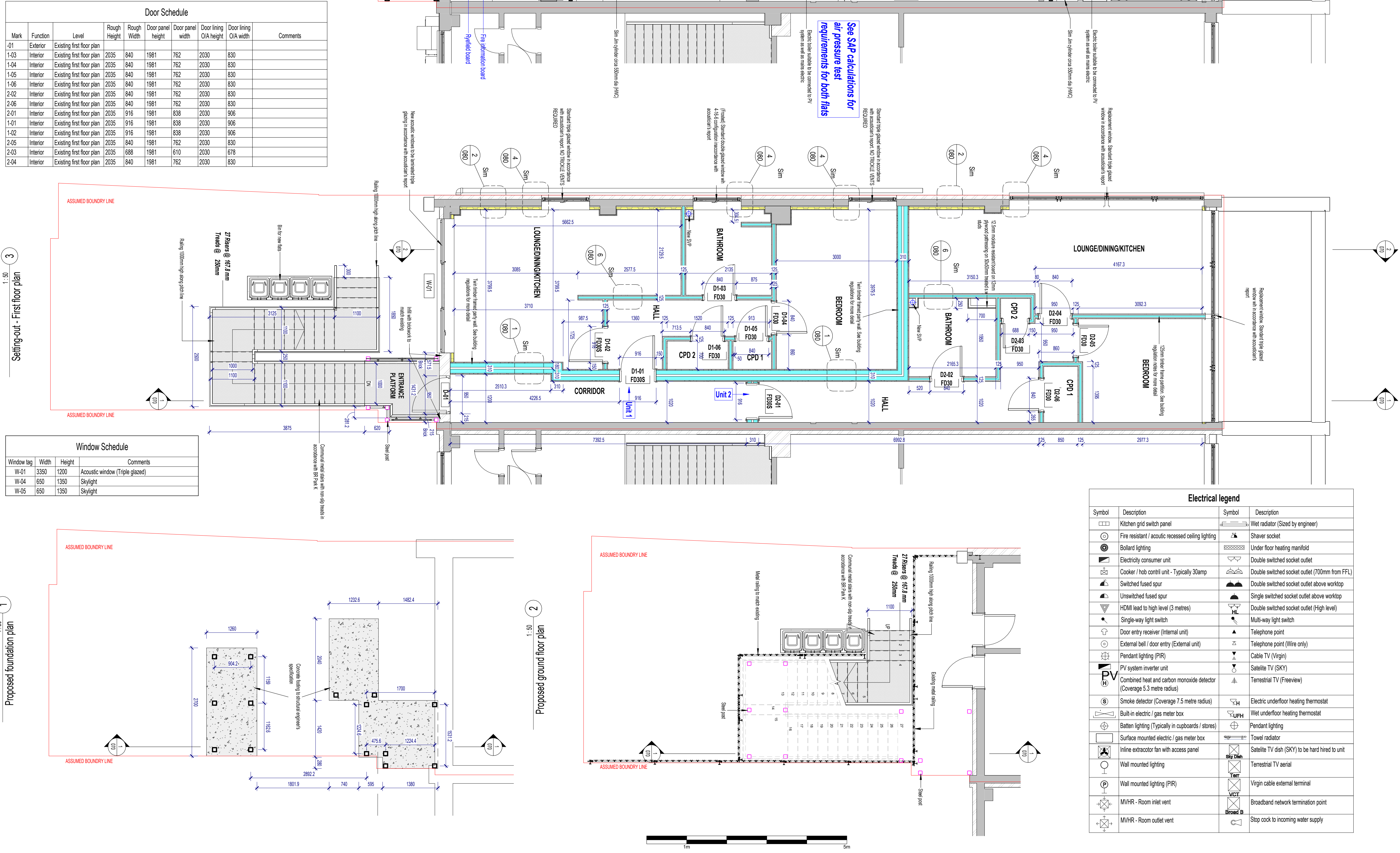

PRELIMINARY

- GENERAL SPECIFICATION NOTES**
1. Do not scale off the drawings on this sheet. Use figured dimensions only. If required, request dimension from the Architect.
  2. All dimensions are in mm unless otherwise stated.
  3. Existing foundations are shown indicatively and must be confirmed on site where required.
  4. All dimensions shall be checked on site by the main contractor prior to commencing works. Errors and omissions are to be reported to the Architect.
  5. All works shall conform to the current edition of the Building Regulations and other statutory requirements.
  6. These drawings are to be read in conjunction with the structural drawings, where provided.
  7. It is the responsibility of the main contractor to ensure accurate integrity and the integrity of separating form and separating walls between residential units. Sealing around service penetrations, ceiling and wall linings between residential units are to be done in accordance with best practice and industry standard.
  8. It is the responsibility of the main contractor to ensure separating walls and separating floors pass sound tests carried out on site in accordance with Building Control requirements.
  9. All materials and workmanship shall conform with the relevant British Standard specifications and codes of practice.
  10. This drawing may incorporate information from other professions. The Architect cannot accept responsibility for the integrity and accuracy of such information. Any clarification and/or additions that are required appearing to such information should be sought from the relevant professional or their appointed representative.

**Communal stairs (General access)**

1. Make step nosing apparent by using material that contrast visually, 50mm to 65mm wide on the tread and 30mm to 55mm on the riser
2. Tread nosing must not exceed 25mm.
3. Risers must be closed.
4. Must have level treads on steps, ensuring that the rise and going of each step are consistent throughout a flight of steps.
5. Hand railings must be non-climbable with gaps not wide enough to allow a sphere of 100mm dia. go through.
6. Min. stair width of 1000mm between handrails.
7. Landings must be a min. 1000mm between hand rails.
8. Maximum of 12no. risers in a flight.
9. The ground directly in front of the bottom tread must be level and paved and made permanently firm.

Symbol	Description	Symbol	Description
	Kitchen grid switch panel		Wet radiator (Sized by engineer)
	Fire resistant / acoustic recessed ceiling lighting		Shaver socket
	Bollard lighting		Under floor heating manifold
	Electricity consumer unit		Double switched socket outlet
	Cooker / hob control unit - Typically 30amp		Double switched socket outlet (700mm from FFL)
	Switched fused spur		Double switched socket outlet above worktop
	Unswitched fused spur		Single switched socket outlet above worktop
	HDMI lead to high level (3 metres)		Double switched socket outlet (High level)
	Single-way light switch		Multi-way light switch
	Door entry receiver (Internal unit)		Telephone point
	External bell / door entry (External unit)		Telephone point (Wire only)
	Pendant lighting (PIR)		Cable TV (Virgin)
	PV system inverter unit		Satellite TV (SKY)
	Combined heat and carbon monoxide detector (Coverage 5.3 metre radius)		Terrestrial TV (Freeview)
	Smoke detector (Coverage 7.5 metre radius)		Electric underfloor heating thermostat
	Built-in electric / gas meter box		Wet underfloor heating thermostat
	Batten lighting (Typically in cupboards / stores)		Pendant lighting
	Surface mounted electric / gas meter box		Towel radiator
	Inline extractor fan with access panel		Satellite TV dish (SKY) to be hard hired to unit
	Wall mounted lighting		Terrestrial TV aerial
	Wall mounted lighting (PIR)		Virgin cable external terminal
	MVHR - Room inlet vent		Broadband network termination point
	MVHR - Room outlet vent		Stop cock to incoming water supply