

**Key.**

02 No.	1 Bed / 1 Person [1b1p]	03. No 1 Beds
01 No.	1 Bed / 2 Person [1b2p]	
01 No.	2 Bed / 3 Person [2b3p]	03. No 2 Beds
02 No.	2 Bed / 4 Person [2b4p]	
06 No.	TOTAL	06. No

**Communal Residential Areas**  
 Within Application Demise  
 [Ancillary: Cycle Store/Circulation]

**Private Areas**  
 Within Application Demise  
 No Access for Residents

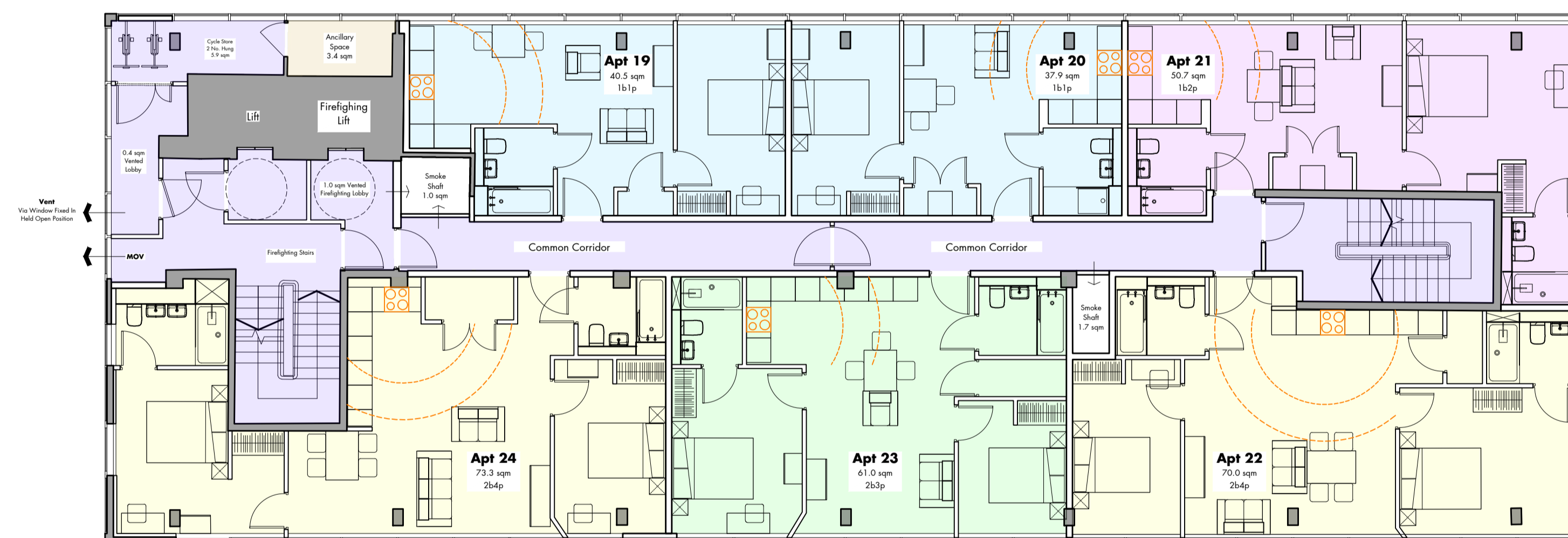

**Copyright**

All rights to the drawings and designs are held by Studio RBA Limited. Reproducing, sharing, or storing any part of this content, either in 2D or 3D format, by any method – including digital, photocopying, or other mechanical processes – without written consent from the copyright holder is strictly prohibited. The content cannot be saved in any digital storage system without the copyright holder's written agreement. The rights and identification of the original creator for these designs are reserved.

The drawings and designs were produced by the copyright holder under an exclusive agreement for a specific client. Use of this content is restricted to this client based on the license's terms. Any permissions granted by the copyright holder under this license cease once the license ends or if the licensee faces insolvency issues.

Studio RBA Limited disclaims any liability for unauthorised or unlicensed use of the designs and for any actions based on them. Construction based on these designs is not allowed unless there's explicit written approval from the copyright holder.

**Scale & Orientation**

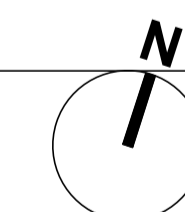
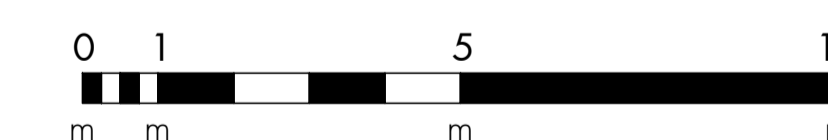

# Studio RBA.

www.studiiorba.co.uk @studiiorba Royal Albert Dock, Unit 32b, The Colonnades, Liverpool, L3 4AA +44 (0)151 607 2040 info@studiiorba.co.uk

Project. Nicholsons House, Maidenhead, SL6 1LD

Drawing No. RBA\_286\_[2-]\_A106 Workstage. 2/3

Note. Revised to HSE Comments Revision. R5

Paper. A1 Drawn. JJ Checked. AM Scale. 1:100

Client. Aegon UK Property Fund Limited c/o Columbia Threadneedle Investments Date. 07.08.2024

**Proposed Fourth Floor Plan**