

NOTE - Responsibility is not accepted for errors made by others in scaling from this drawing. All construction information should be taken from figured dimensions only

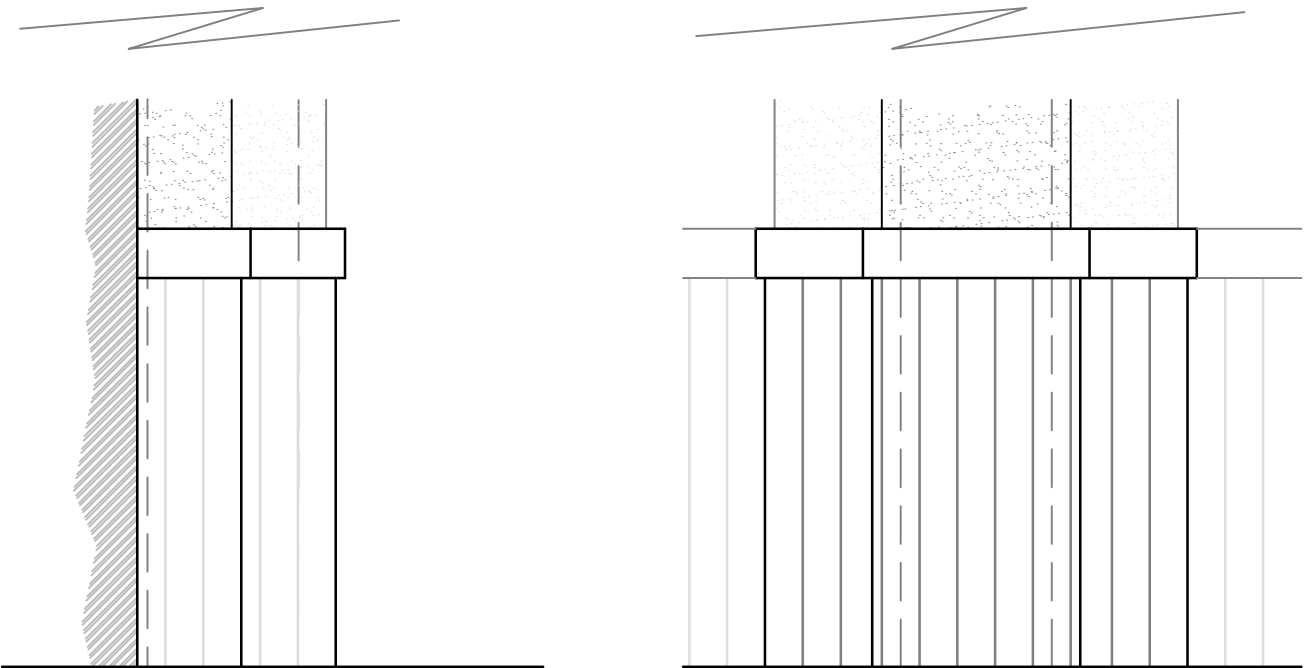

MATERIALS

- Decorative head to be reinstated.
- Plasterboard fire encasement around column and cross bracing, skimmed and painted to match.
- Where pier intersects wall panelling, the panelling to be reinstated around the pier .



REVISIONS

kdpa

Brooklyn Chambers, 11 Goring Road,
Worthing, West Sussex BN12 4AP
+44 (0)1903 496 999 www.kdpaine.co.uk

CLIENT	SLEEK DIRECT INTERNATIONAL LTD	
PROJECT	THE STATE CINEMA GEORGE STREET, GRAYS, ESSEX RM1 7 GLY	
DRAWING	PROPOSED MAIN HALL PIER DETAILS	

SCALE A3 / 1:20	DATE FEB 25	DRAWN AKS / TL
PROJECT No 7839	DRAWING No PL-411	REVISION Draft 5

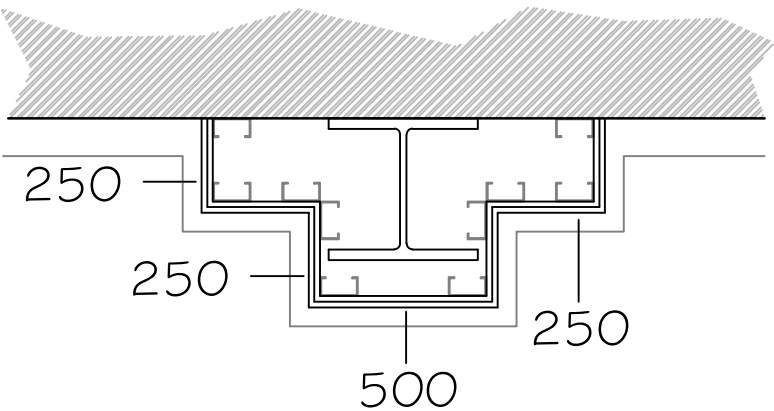

DETAILS SCALE 1:20

PRELIMINARY